

SIZE:210\*297MM

INSTRUCTION

Thank you for purchasing the spa/pool vacuum cleaner.

The spa/pool vacuum cleaner is a hand held battery operated cleaner which is easy to use. It saves water and reduces chemical consumption in the cleaning process. It is suitable for most spa, and above-ground pools.

Please note that the outlet hole of the lower body (the right photo) must be submerged during operation to avoid damage to the pump. It is designed to collect floor and seat debris – it is not a surface skimming device.

8 AA sized batteries are not included in it.

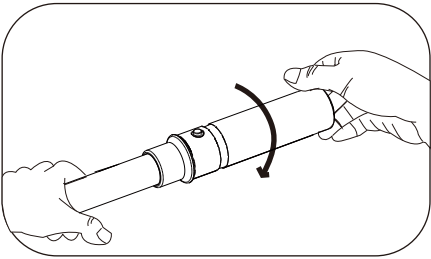
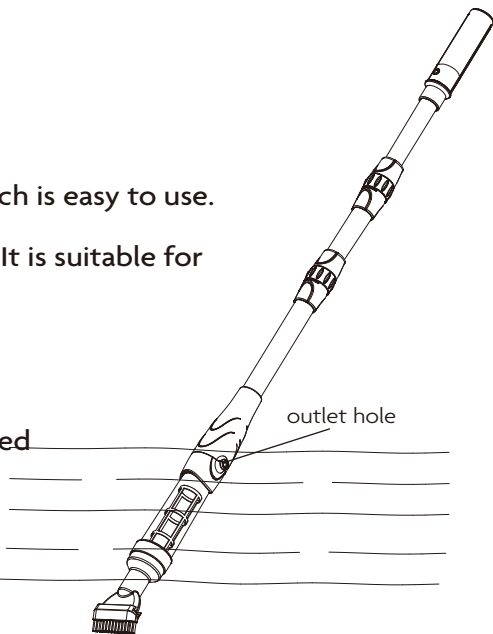

1. Screw off the cap anticlockwise from the top of handle.

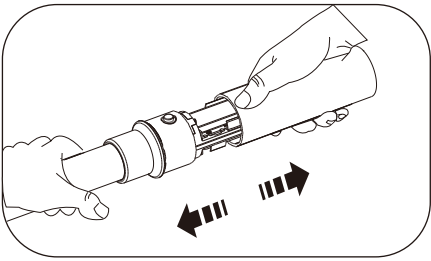

2. Pull the handle cover gently to expose the battery compartment.

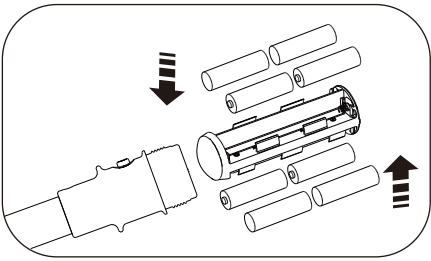

3. Place the 8 AA sized batteries into allotted areas of battery compartment correctly.

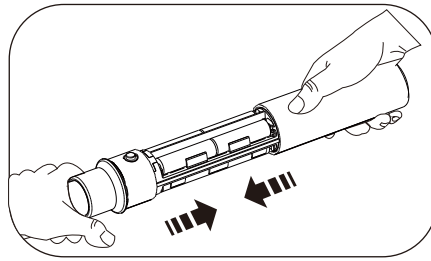

4. Slide the handle cover back.

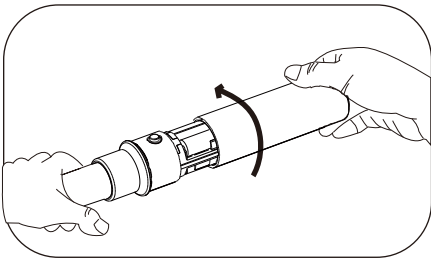

5. Screw the cap clockwise on the top of handle.

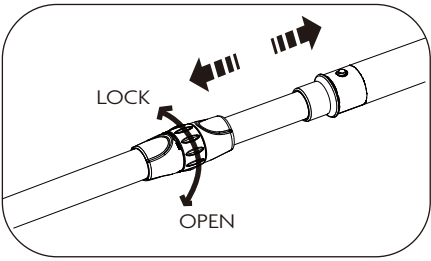

6. Turn the ring in anti clockwise until feel it stop, adjust the length of alu pole you want, then turn the ring in clockwise to lock it.

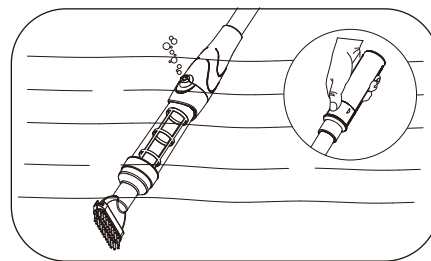

7. Place the motorized head (not the handle) of cleaner into the spa/pool and turn on the power by pressing the button.

Cleaner comes with two nozzles and one brush that have three special uses. They are already attached to the cleaner.



DUAL-END NOZZLE

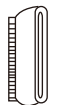

SLIDE-ON BRUSH



WIDE-END NOZZLE

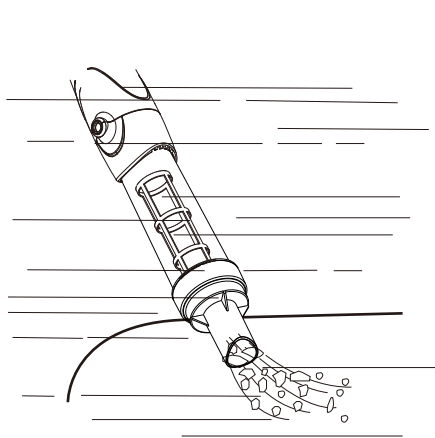

A. To remove rocks and large debris from the Spa/Pool bottom.

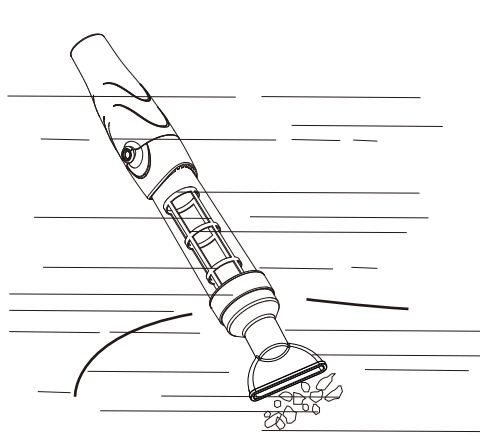

B. To remove the floating debris in the deep water from Spa/Pool Bottom.

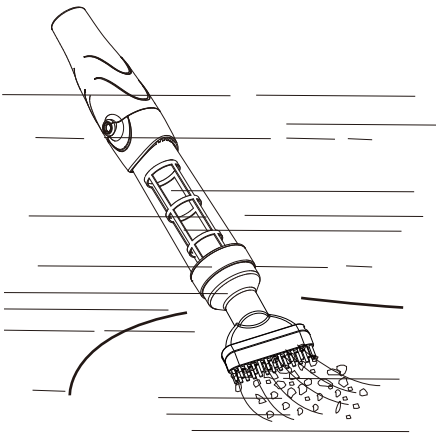

C. To brush and remove dirt from the Spa/Pool bottom.

When it have no power check if the batteries were loose or wrong placed, when it is weak powered after some time using, it is time for batteries replacement.

How to clean the filter:

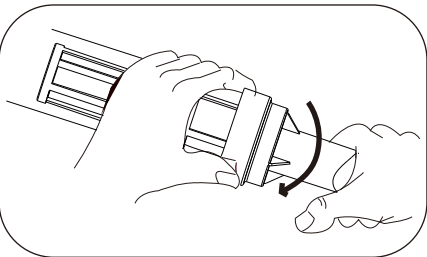

1. Rotate the End-Cup Assembly anticlockwise.

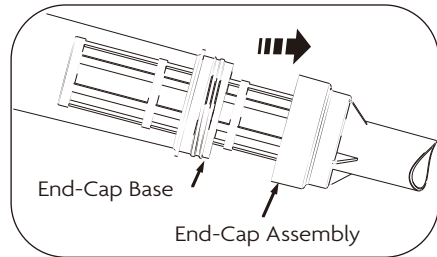

2. Gently pull the End-Cup Assembly out.

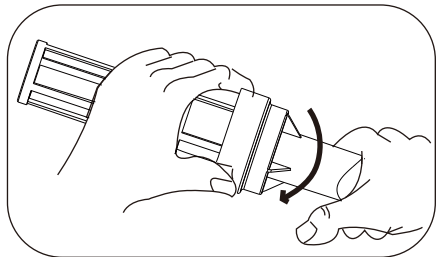

3. Hold the Assembly and Rotate it anticlockwise by about 30° until you feel it stop.

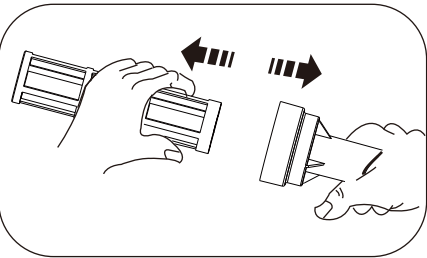

4. Pull off the filter screen and take out the debris.

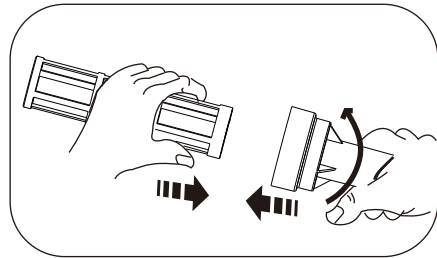

5. Line up the notches and slide the filter screen onto the assembly and gently rotate the assembly clockwise 30° turn until the filter screen locks into place. Rinse out any fine silt and flush any grit from the assembly. Make sure the seal ring inside the End-Cup Assembly is flat and no grit on it.

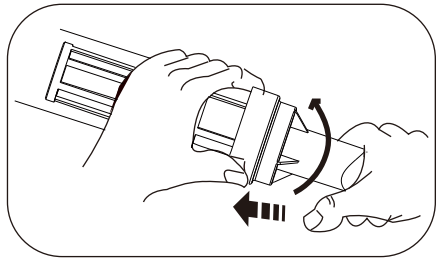

6. Rotate End-Cup Assembly back into body and lock tight.

GENERAL MAINTENANCE

To ensure longevity of your cleaner some basic maintenance is required.

1. Periodically check the batteries for any sign of leakage, for prolonged storage remove the batteries.
2. Rinse the cleaner off after use with fresh water to prevent chemical damage.
3. Ensure the filter is clean after each use.
4. Never leave out in direct sunlight.
5. When testing the cleaner never run the motor out of water.
6. Never take the pump apart without prior consultation with the manufacturer.

TROUBLE SHOOTING

When the cleaner doesn't work, please pay attention to the following solutions.

1. Ensure positive ends of the batteries interface with the positive contact.
2. Ensure the battery compartment is clean before each use, especially the positive and negative contacts.

12V --- LR 6 / AA x 8 (NOT INCLUDED)



IPX7

Made in China